

# SMD Semi-Shielded Power Inductor - SNR4020 Series **Meisongbei**



## Features

- Magnetic-resin Shielded reduces noise
- Inductance Range: 1uH - 82uH
- Rated current up to 4.78A
- Small and very Thin inductor

## Application

- LED Lighting,
- Automotive systems,
- Notebooks, desktop computers, servers, graphic cards.

## General Specifications

- Storage temp range: -40°C to +85°C
- Operating temp range: -40°C to +125°C
- Resistance to Soldering Heat +260°C for 5-10 Sec.

## ► Dimensions & Configurations (Unit:mm)

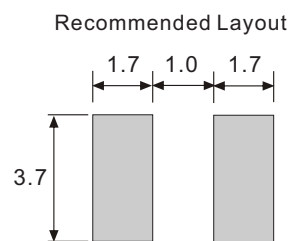
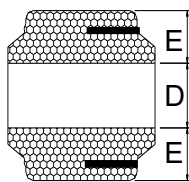
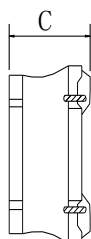
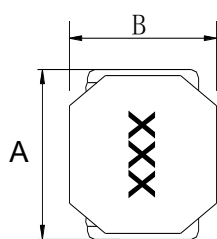

Type	A	B	C	D	E
SNR4020	4.0±0.2	4.0±0.2	2.1Max	1.4±0.2	1.3±0.2

## ► Electrical Characteristics For SNR4020 Series

Part Number	Inductance [uH]	DCR(max) [mΩ]	Isat [A] (Max.)
SNR4020-1R0N	1.0±30%	41.88	4.78
SNR4020-1R5N	1.5±30%	50.6	4.45
SNR4020-2R2N	2.2±30%	54.6	3.40
SNR4020-3R3M	3.3±20%	95.8	3.20
SNR4020-4R7M	4.7±20%	102.9	2.35
SNR4020-6R8M	6.8±20%	171.2	2.15
SNR4020-100M	10±20%	225	1.60
SNR4020-150M	15±20%	314	1.35
SNR4020-220M	22±20%	477	1.05
SNR4020-330M	33±20%	750	0.85
SNR4020-470M	47±20%	969	0.74
SNR4020-680M	68±20%	1449	0.61
SNR4020-820M	82±20%	1596	0.50