

Material: M3, MC95, M5K, M7K, M10K, M12K

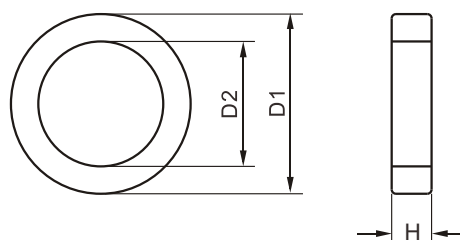

Type	Dimension(mm)			Weight (g)	Effective Parameter				AL(nH/N ²)					
	D1	D2	H		C1 (mm ⁻¹)	Le (mm)	Ae (mm ²)	Ve (mm ³)	M3 (±30%)	MC95 (±30%)	M5K (±30%)	M7K (±30%)	M10K (±30%)	M12K (±30%)
T6x3x2	6.0±0.3	3.0±0.3	2.0±0.2	0.18	4.53	13.06	2.88	37.66	620	880	1500	1900	2700	3200
T6x3x3	6.0±0.3	3.0±0.3	3.0±0.2	0.28	3.02	13.06	4.32	56.49	1000	1350	2250	3150	4200	4800
T8x4x3	8.0±0.3	4.0±0.3	3.0±0.3	0.52	3.02	17.42	5.76	100.43	920	1350	2200	2800	4200	5000
T8x4x4	8.0±0.3	4.0±0.3	4.0±0.3	0.71	2.26	17.42	7.68	133.91	1300	1700	2800	3700	5500	6600
T8x5x3	8.0±0.3	5.0±0.3	3.0±0.2	0.45	4.45	19.68	4.41	86.98	640	900	1500	1950	2800	3400
T9x5x3	9.0±0.3	5.0±0.3	3.0±0.2	0.6	3.56	20.77	5.83	121.11	800	1100	1800	2600	3500	4200
T9x5x4	9.0±0.3	5.0±0.3	4.0±0.2	0.81	2.67	20.77	7.77	161.48	1000	1500	2500	3200	4600	5500
T9x5x5	9.0±0.3	5.0±0.3	5.0±0.2	1.02	2.13	20.77	9.71	201.86	1300	1900	3100	4000	5700	6900
T9x5x7	9.0±0.3	5.0±0.3	7.0±0.2	1.42	1.52	20.77	13.6	282.6	1850	2650	4400	5600	8000	9600
T9.53x5.59x3.2	9.53±0.3	5.59±0.3	3.2±0.2	0.75	3.68	22.66	6.15	139.51	770	1100	1800	2300	3500	4000
T10x5x3	10.0±0.3	5.0±0.3	3.0±0.3	0.8	3.02	21.77	7.2	156.93	920	1300	2200	2800	4000	4800
T10x5x5	10.0±0.3	5.0±0.3	5.0±0.3	1.44	1.81	21.77	12.01	261.55	1700	2200	3600	4700	6900	8300
T10x6x2.8	10.0±0.3	6.0±0.3	2.8±0.2	0.7	4.38	24.07	5.47	131.91	650	930	1600	2000	2800	3400
T10x6x3.5	10.0±0.3	6.0±0.3	3.5±0.2	0.85	3.51	24.07	6.84	164.88	800	1200	1900	2500	3500	4200
T10x6x4	10.0±0.3	6.0±0.3	4.0±0.2	0.96	3.07	24.07	7.82	188.44	1000	1200	2200	2800	4100	4900
T10x6x5	10.0±0.3	6.0±0.3	5.0±0.3	1.2	2.46	24.07	9.78	235.55	1200	1700	2800	3500	5000	6000
T12x6x4	12.0±0.4	6.0±0.3	4.0±0.3	1.6	2.26	26.13	11.53	301.31	1300	1700	2900	3700	5500	6600
T12x6x6	12.0±0.4	6.0±0.3	6.0±0.3	2.3	1.51	26.13	17.29	451.97	1800	2600	4400	5600	8000	9600
T12.7x7.92x4.5	12.7±0.4	7.92±0.3	4.5±0.3	1.6	2.95	31.21	10.55	329.56	960	1400	2300	2900	4200	5000
T12.7x7.92x4.7	12.7±0.4	7.92±0.3	4.7±0.3	1.7	2.83	31.21	11.02	344.21	1000	1400	2400	3100	4400	5200
T12.7x7.92x4.9	12.7±0.4	7.92±0.3	4.9±0.3	1.8	2.71	31.21	11.49	358.86	1000	1500	2500	3200	4500	5500
T12.7x7.92x5	12.7±0.4	7.92±0.3	5.0±0.3	1.8	2.66	31.21	11.73	366.18	1000	1500	2600	3200	4600	5600
T12.7x7.92x6	12.7±0.4	7.92±0.3	6.0±0.3	2.2	2.21	31.21	14.07	439.42	1100	1500	2600	3200	4600	5600
T12.7x7.92x6.35	12.7±0.4	7.92±0.3	6.35±0.3	2.3	2.09	31.21	14.89	465.05	1400	1900	3200	4100	6000	7200
T13x7x3.5	13.0±0.4	7.0±0.3	3.5±0.3	1.4	2.89	29.49	10.17	300	970	1400	2300	2900	4200	5000
T13x7x5	13.0±0.4	7.0±0.3	5.0±0.3	2.3	2.02	29.49	14.53	428.57	1400	2000	3300	4200	6000	7200
T13x7x6	13.0±0.4	7.0±0.3	6.0±0.3	2.6	1.69	29.49	17.43	514.28	1700	2400	4000	5000	7200	8600
T14x7x7	14.0±0.4	7.0±0.3	7.0±0.3	3.9	1.29	30.48	23.54	717.71	2200	3100	5100	6500	9300	11200
T14x8x3	14.0±0.4	8.0±0.3	3.0±0.3	1.4	3.74	32.81	8.76	287.76	750	1100	1800	2300	3300	3900
T14x8x4	14.0±0.4	8.0±0.3	4.0±0.3	1.9	2.8	32.81	11.69	383.69	1100	1400	2400	3100	4500	5400

Material: M3, MC95, M5K, M7K, M10K, M12K

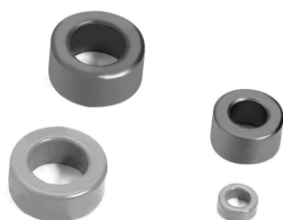
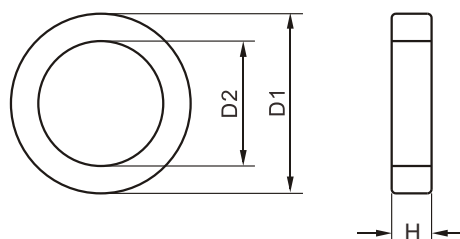
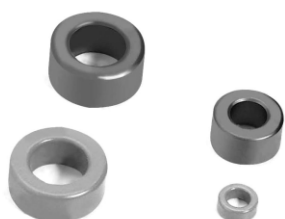

Type	Dimension(mm)			Weight (g)	Effective Parameter				AL(nH/N ²)					
	D1	D2	H		C1 (mm ⁻¹)	Le (mm)	Ae (mm ²)	Ve (mm ³)	M3 (±30%)	MC95 (±30%)	M5K (±30%)	M7K (±30%)	M10K (±30%)	M12K (±30%)
T14x8x5	14.0±0.4	8.0±0.3	5.0±0.3	2.3	2.24	32.81	14.61	479.61	1300	1800	3000	3800	5500	6600
T14x8x6	14.0±0.4	8.0±0.3	6.0±0.3	2.9	1.87	32.81	17.53	575.53	1500	2200	3600	4600	6500	7900
T14x8x7	14.0±0.4	8.0±0.3	7.0±0.3	3.5	1.6	32.81	20.46	671.46	1800	2500	4200	5300	7900	9500
T14x8x8	14.0±0.4	8.0±0.3	8.0±0.3	3.9	1.4	32.81	23.38	767.38	2000	2900	4800	6100	8700	10500
T14x8x9	14.0±0.4	8.0±0.3	9.0±0.3	4.4	1.24	32.81	26.3	863.3	2300	3200	5400	6900	9800	11800
T14x7x9	14.0±0.4	7.0±0.3	9.0±0.3	5	1	30.48	30.26	922.77	2800	4000	6600	8400	12000	14400
T14x9x5	14.0±0.4	9.0±0.3	5.0±0.3	2.1	2.84	24.97	12.29	430.19	1100	1300	2400	3000	4400	5300
T14x9x8	14.0±0.4	9.0±0.3	8.0±0.3	3.4	1.77	34.97	19.67	688.31	1600	2300	3800	4900	7000	8400
T14x10x2.6	14.0±0.3	10.0±0.3	2.3±0.3	0.85	7.18	36.99	5.15	190.57	400	570	950	1200	1700	2100
T14.6x10.5x3.7	14.6±0.3	10.5±0.3	3.7±0.3	1.5	5.19	39.41	7.58	298	550	800	1300	1700	2400	2900
T16x9x5	16.0±0.4	9.0±0.3	5.0±0.3	3.2	2.18	37.18	17.02	633.03	1300	1900	3100	3900	5600	6700
T16x9x6	16.0±0.4	9.0±0.3	6.0±0.3	3.9	1.82	37.18	20.43	759.67	1550	2200	3700	4700	6700	8000
T16x9x7	16.0±0.4	9.0±0.3	7.0±0.3	4.6	1.56	37.18	23.83	886.28	1800	2600	4300	5500	7800	9400
T16x9x8	16.0±0.4	9.0±0.3	8.0±0.3	5.3	1.36	37.18	27.24	1012.9	2100	3000	5000	6300	9000	10800
T16x9.5x5	16.0±0.4	9.5±0.3	5.0±0.3	3.1	2.41	38.29	15.88	608.42	1200	1700	2800	3600	5100	6100
T16x9.5x6.3	16.0±0.4	9.5±0.3	6.3±0.3	3.9	1.91	38.29	20.01	766.61	1500	2100	3500	4500	6400	7700
T16x9.5x8	16.0±0.4	9.5±0.3	8.0±0.3	4.9	1.5	38.29	25.41	973.47	1900	2700	4500	5700	8200	9800
T16x9.6x6.1	16.0±0.4	9.6±0.3	6.1±0.3	3.8	2.01	38.51	19.1	735.68	1400	2000	3400	4300	6100	7300
T16x9.6x6.35	16.0±0.4	9.6±0.3	6.35±0.3	3.9	1.93	38.51	19.88	765.83	1500	2100	3500	4500	6400	7600
T16x9.6x8	16.0±0.4	9.6±0.3	8±0.3	5	1.53	38.51	25.05	964.82	1900	2700	4400	5600	8000	9600
T16x10x4	16.0±0.4	10.0±0.3	4.0±0.3	2.3	3.34	39.37	11.78	463.89	850	1200	2000	2600	3700	4400
T16x10x5	16.0±0.4	10.0±0.3	5.0±0.3	2.9	2.67	39.37	14.72	579.87	1100	1500	2500	3200	4600	5500
T16x10x6	16.0±0.4	10.0±0.3	6.0±0.3	3.5	2.22	39.37	17.67	695.84	1300	1800	3100	3900	5500	6600
T16x10x6.35	16.0±0.4	10.0±0.3	6.35±0.3	3.7	2.1	39.37	18.7	736.43	1400	1900	3200	4100	5900	7000
T16x10x6.5	16.0±0.4	10.0±0.3	6.5±0.3	3.7	2.05	39.37	19.14	753.83	1400	2000	3300	4200	6000	7200
T16x10x7	16.0±0.4	10.0±0.3	7.0±0.3	4.1	1.9	39.37	20.61	811.81	1480	2100	3600	4500	6600	7900
T16x10x8	16.0±0.4	10.0±0.3	8.0±0.3	4.7	1.67	39.37	23.56	927.79	1700	2400	4100	5200	7400	8900
T16x12x4	16.0±0.3	12.0±0.3	4.0±0.3	1.8	5.46	43.38	7.94	344.66	530	750	1300	1600	2300	2800
T16x12x8	16.0±0.3	12.0±0.3	8.0±0.3	3.4	2.75	43.96	16	703	1100	1500	2500	3200	4500	5400
T18x10x6	18.0±0.4	10.0±0.3	6.0±0.3	4.9	1.78	41.54	23.32	968.93	1600	2300	3800	4800	6900	8300

Material: M3, MC95, M5K, M7K, M10K, M12K

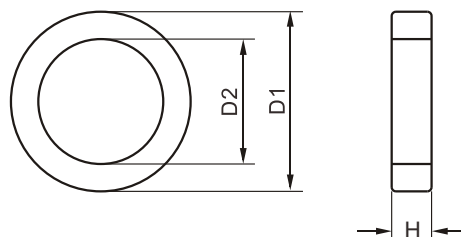

Type	Dimension(mm)			Weight (g)	Effective Parameter				AL(nH/N ²)					
	D1	D2	H		C1 (mm ⁻¹)	Le (mm)	Ae (mm ²)	Ve (mm ³)	M3 (±30%)	MC95 (±30%)	M5K (±30%)	M7K (±30%)	M10K (±30%)	M12K (±30%)
T18x10x6.35	18.0±0.4	10.0±0.3	6.35±0.3	5	1.68	41.54	24.68	1025.45	1700	2400	4000	5100	7300	8700
T18x10x7	18.0±0.4	10.0±0.3	7.0±0.3	5.8	1.52	41.54	27.2	1130.42	1800	2600	4400	5600	8000	9600
T18x10x8	18.0±0.4	10.0±0.3	8.0±0.3	6.8	1.33	41.54	31.09	1291.91	2100	3000	5000	6400	9200	11000
T18x10x10	18.0±0.4	10.0±0.3	10.0±0.3	8.3	1.06	41.54	38.86	1614.89	2600	3800	6300	8000	11500	14000
T18x10x15	18.0±0.4	10.0±0.3	15.0±0.3	13.3	0.71	41.54	58.3	2422.34	3900	5700	9400	12000	17100	20600
T18x12x5	18.0±0.3	12.0±0.3	5.0±0.3	3.4	3.09	45.85	14.79	678.5	920	1300	2200	2800	4000	4800
T18x12x6	18.0±0.3	12.0±0.3	6.0±0.3	4	2.58	45.85	17.75	814.21	1100	1600	2600	3400	4800	5800
T18x12x8	18.0±0.3	12.0±0.3	8.0±0.3	5.4	1.93	45.85	23.67	1085.61	1500	2100	3500	4500	6400	7700
T18.7x10.2x4	18.7±0.5	10.2±0.5	4.0±0.2	3.3	2.59	42.73	16.48	704.58	1100	1600	2600	3300	4700	5600
T19x9x10	19.0±0.4	9.0±0.3	10.0±0.3	10.5	0.84	40.14	47.73	1916.23	3300	4700	7900	10000	14500	17500
T19x11x5	19.0±0.4	11.0±0.3	5.0±0.3	4.8	2.29	44.85	19.5	875.13	1200	1800	2900	3700	5500	6500
T19x11x10	19.0±0.4	11.0±0.3	10.0±0.3	9.5	1.14	44.85	39.01	1750.27	2500	3500	5900	7500	11000	13000
T19x12.5x9.6	19.0±0.4	12.5±0.3	9.6±0.3	7.4	1.56	48.06	30.74	1477.85	1800	2600	4400	5600	7900	9500
T19x13x5	19.0±0.4	13.0±0.3	5.0±0.3	3.5	3.31	49.07	14.82	727.41	870	1300	2100	2600	3800	4500
T19x13x6	19.0±0.4	13.0±0.3	6.0±0.3	4.2	2.75	49.07	17.78	872.89	1100	1400	2500	3200	4600	5500
T19x13x11	19.0±0.4	13.0±0.3	11.0±0.3	8	1.5	49.07	32.6	1600.3	2000	2700	4500	5800	8300	10000
T19x13x12	19.0±0.4	13.0±0.3	12.0±0.3	8.8	1.37	49.07	35.57	1745.79	2100	3000	5000	6300	9000	11000
T20x10x7	20.0±0.4	10.0±0.3	7.0±0.3	7.5	1.29	43.55	33.63	1464.71	2300	3100	5100	6800	9700	11600
T20x10x8	20.0±0.4	10.0±0.3	8.0±0.3	8.6	1.13	43.55	38.43	1673.96	2700	3500	5900	7500	11100	13300
T20x10x10	20.0±0.4	10.0±0.3	10.0±0.3	11.2	0.9	43.55	48.04	2092.45	3300	4400	7300	9400	13800	16600
T20x11x6	20.0±0.4	11.0±0.4	6.0±0.3	6.3	1.75	45.91	26.21	1203.31	1600	2300	3800	4900	7000	8500
T20x11x7	20.0±0.4	11.0±0.4	7.0±0.3	7.4	1.5	45.91	30.57	1403.86	1900	2700	4500	5700	8200	9800
T20x11x10	20.0±0.4	11.0±0.4	10.0±0.3	10.5	1.05	45.91	43.68	2005.57	2700	3800	6400	8200	11600	14000
T20x12x6	20.0±0.4	12.0±0.4	6.0±0.3	5.5	2.05	48.14	23.48	1130.65	1400	2000	3300	4200	6000	7200
T20x12x6.35	20.0±0.4	12.0±0.4	6.35±0.3	6	1.93	48.14	24.85	1196.61	1500	2100	3500	4400	6400	7700
T20x12x7	20.0±0.4	12.0±0.4	7.0±0.3	6.6	1.75	48.14	27.39	1319.1	1600	2300	3900	4900	7000	8400
T20x12x8	20.0±0.4	12.0±0.4	8.0±0.3	7.7	1.53	48.14	31.31	1507.54	1900	2700	4400	5600	8200	9800
T20x12x10	20.0±0.4	12.0±0.4	10.0±0.3	9.8	1.23	48.14	39.14	1884.43	2300	3300	5500	7000	10000	12000
T22x13.7x6.35	22.0±0.4	13.7±0.4	6.35±0.3	7.1	2.07	54.03	26.06	1408.61	1400	2000	3300	4200	6200	7300
T22x14x4	22.0±0.4	14.0±0.4	4.0±0.3	4.4	3.47	54.66	15.73	859.95	830	1200	2000	2600	3700	4400

Material: M3, MC95, M5K, M7K, M10K, M12K

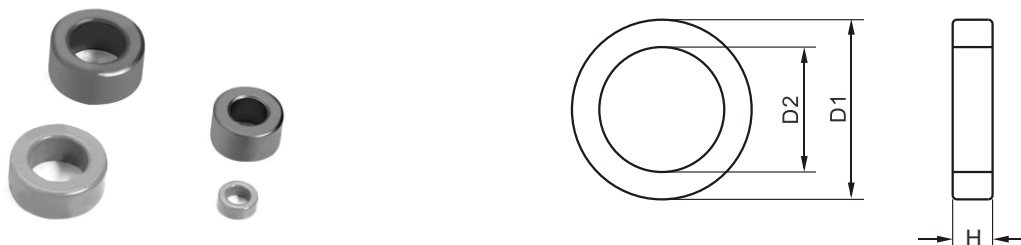

Type	Dimension(mm)			Weight (g)	Effective Parameter				AL(nH/N ²)					
	D1	D2	H		C1 (mm ⁻¹)	Le (mm)	Ae (mm ²)	Ve (mm ³)	M3 (±30%)	MC95 (±30%)	M5K (±30%)	M7K (±30%)	M10K (±30%)	M12K (±30%)
T22x14x6	22.0±0.4	14.0±0.4	6.0±0.3	6.5	2.31	54.66	23.59	1289.92	1200	1800	3000	3800	5500	6500
T22x14x6.35	22.0±0.4	14.0±0.4	6.35±0.3	6.5	2.18	54.66	24.97	1365.17	1300	1900	3100	4000	5700	6800
T22x14x6.5	22.0±0.4	14.0±0.4	6.5±0.3	7	2.13	54.66	25.56	1397.42	1400	2000	3200	4100	5800	6900
T22x14x7	22.0±0.4	14.0±0.4	7.0±0.3	7.2	1.95	54.66	27.52	1504.91	1500	2100	3400	4400	6200	7500
T22x14x8	22.0±0.4	14.0±0.4	8.0±0.3	8.8	1.73	54.66	31.46	1719.9	1700	2300	4000	5000	7200	8600
T22x14x9	22.0±0.4	14.0±0.4	9.0±0.3	9.3	1.54	54.66	35.39	1934.89	1800	2600	4400	5600	8000	9600
T22x14x10	22.0±0.4	14.0±0.4	10.0±0.3	10.8	1.39	54.66	39.32	2149.87	2100	2900	5000	6300	9000	10700
T22x14x12	22.0±0.4	14.0±0.4	12.0±0.3	13.2	1.15	54.66	47.19	2576.85	2500	3500	5900	7500	10700	12800
T22x14x12.7	22.0±0.4	14.0±0.4	12.7±0.3	14.2	1.09	54.66	49.94	2730.34	2600	3700	6200	7900	11500	13700
T22x14x13	22.0±0.4	14.0±0.4	13±0.3	14.6	1.06	54.66	51.12	2794.84	2700	3800	6400	8100	11700	14000
T25x15x4	25.0±0.4	15.0±0.4	4.0±0.3	5.8	3.07	60.18	19.57	1177.77	1000	1300	2200	2800	4000	4800
T25x15x7	25.0±0.4	15.0±0.4	7.0±0.3	10	1.75	60.18	34.24	2061.09	1600	2300	3900	4900	7000	8500
T25x15x8	25.0±0.4	15.0±0.4	8.0±0.3	12	1.53	60.18	39.14	2355.54	1800	2600	4400	5600	8000	9700
T25x15x9	25.0±0.4	15.0±0.4	9.0±0.3	13.1	1.36	60.18	44.03	2649.98	2100	3000	5000	6300	9000	11000
T25x15x10	25.0±0.4	15.0±0.4	10.0±0.3	14.9	1.23	60.18	48.92	2944.42	2400	3400	5600	7200	10200	12200
T25x15x12	25.0±0.4	15.0±0.4	12.0±0.3	18	1.02	60.18	58.71	3533.31	2800	4000	6800	8600	12000	14600
T25x15x13	25.0±0.4	15.0±0.4	13.0±0.3	19.5	0.94	60.18	63.6	3827.75	3200	4300	7300	9300	13200	15800
T25x15x15	25.0±0.4	15.0±0.4	15.0±0.3	22.4	0.82	60.18	73.39	4416.63	3700	4900	8300	10700	15200	18200
T26x14.5x10	26.0±0.5	14.5±0.4	10.0±0.3	17.3	1.07	60.14	55.89	3361.46	2700	3800	6300	8000	11500	13800
T26x14.5x15	26.0±0.5	14.5±0.4	15.0±0.3	26.9	0.71	60.14	83.84	5042.2	4000	5700	9500	12100	17200	20600
T26x14.5x20	26.0±0.5	14.5±0.4	20.0±0.4	36.5	0.53	60.14	111.78	6722.93	5300	7500	12600	16100	22900	27500
T28x16x12	28.0±0.4	16.0±0.4	12.0±0.3	23.9	0.93	65.63	70.15	4604.31	3100	4400	7300	9300	13300	15900
T28x16x13	28.0±0.4	16.0±0.4	13.0±0.3	26	0.86	65.63	75.99	4988	3300	4800	7900	10000	14300	17200
T28x16x15	28.0±0.4	16.0±0.4	15.0±0.3	30.1	0.74	65.63	87.68	5755.38	3900	5500	9100	11600	16600	19800
T28x16x16	28.0±0.4	16.0±0.4	16.0±0.3	31.8	0.7	65.63	93.53	6139.08	4100	5800	9700	12300	17700	21200
T28x18x12	28.0±0.4	18.0±0.4	12.0±0.3	20.2	1.85	69.95	59.03	4129.86	2500	3500	5800	7400	10600	12700
T28x18x13	28.0±0.4	18.0±0.4	13.0±0.3	22	1.09	69.95	63.95	4474.02	2700	3800	6300	8000	11500	13800
T29x18x15	29.0±0.5	18.0±0.5	15.0±0.3	29	0.87	71.1	80.95	5755.91	3300	4700	7800	10000	14200	17000
T29x19x7	29.0±0.5	19.0±0.5	7.0±0.3	12.1	2.12	73.19	34.48	2524.06	1400	2000	3300	4200	6000	7200
T29x19x7.5	29.0±0.5	19.0±0.5	7.5±0.3	13.2	1.98	73.19	36.94	2704.36	1500	2200	3500	4500	6500	7700

Material: M3, MC95, M5K, M7K, M10K, M12K

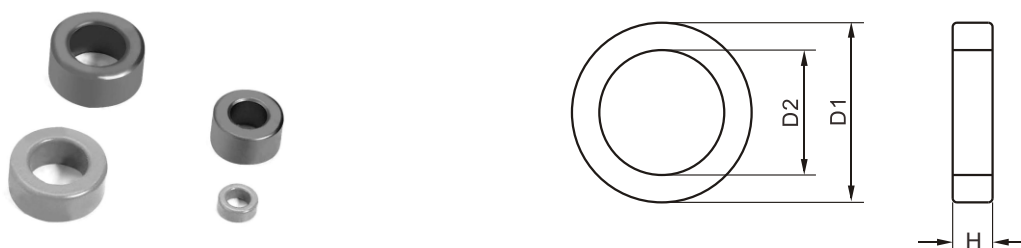

Type	Dimension(mm)			Weight (g)	Effective Parameter				AL(nH/N ²)					
	D1	D2	H		C1 (mm ⁻¹)	Le (mm)	Ae (mm ²)	Ve (mm ³)	M3 (±30%)	MC95 (±30%)	M5K (±30%)	M7K (±30%)	M10K (±30%)	M12K (±30%)
T29x19x8	29.0±0.5	19.0±0.5	8.0±0.3	13.9	1.85	73.19	39.4	2884.65	1600	2300	3800	4800	6900	8200
T29x19x10	29.0±0.5	19.0±0.5	10.0±0.3	17.9	1.48	73.19	49.28	3605.81	2000	3000	4700	6000	8500	10200
T29x19x15	29.0±0.5	19.0±0.5	15.0±0.3	27.2	0.99	73.19	73.89	5408.71	3000	4200	7000	8900	12700	15200
T31x18x14	31.0±0.5	18.0±0.5	14.0±0.3	33.6	0.82	73.3	88.79	6508.86	3500	5000	8300	10500	15100	18100
T31x19x8	31.0±0.5	19.0±0.5	8.0±0.4	17.4	1.6	75.48	47.05	3551.93	1900	2600	4300	5500	7900	9400
T31x19x10	31.0±0.5	19.0±0.5	10.0±0.4	21.5	1.28	75.48	58.81	4439.91	2300	3300	5400	6800	9800	11700
T31x19x12	31.0±0.5	19.0±0.5	12.0±0.4	27.1	1.06	75.48	70.57	5327.89	2800	3900	6400	8200	11700	14000
T31x19x13	31.0±0.5	19.0±0.5	13.0±0.4	29.5	0.98	75.48	76.46	5771.88	3000	4200	7000	8800	12700	15200
T31x19x14	31.0±0.5	19.0±0.5	14.0±0.4	31.6	0.91	75.48	82.34	6215.87	3200	4500	7500	9500	13700	16300
T31x19x15	31.0±0.5	19.0±0.5	15.0±0.4	34.1	0.85	75.48	88.22	6659.86	3400	4800	8000	10200	14600	17500
T31x19x16	31.0±0.5	19.0±0.5	16.0±0.4	36.5	0.8	75.48	94.1	7103.86	3600	5200	8500	10900	15600	18600
T31x19x17	31.0±0.5	19.0±0.5	17.0±0.4	37.8	0.75	75.48	99.98	7547.85	3800	5500	9100	11500	16500	19800
T31x19x18	31.0±0.5	19.0±0.5	18.0±0.4	40.7	0.71	75.48	105.86	7991.84	4000	5800	9600	12200	17500	21000
T31x20x6	31.0±0.5	20.0±0.4	6.0±0.4	12.6	2.38	77.6	32.47	2520.28	1300	1800	2900	3700	5400	6400
T31x20x13	31.0±0.5	20.0±0.4	13.0±0.4	28.2	1.1	77.6	70.36	5460.61	2700	3800	6300	8000	11400	13700
T31x20x14.8	31.0±0.5	20.0±0.4	14.8±0.4	31.3	0.96	77.6	80.1	6216.7	3000	4300	7100	9000	13000	15500
T31x20x15	31.0±0.5	20.0±0.4	15.0±0.4	32.4	0.95	77.6	81.19	6300.71	3100	4300	7200	9200	13000	15700
T31x20x16	31.0±0.5	20.0±0.4	16.0±0.4	34.6	0.89	77.6	86.6	6720.75	3300	4600	7700	9700	14000	16700
T33x21.5x12.5	33.0±0.6	21.5±0.5	12.5±0.4	30.5	1.17	83.04	70.78	5878.32	2500	3600	5900	7500	10800	12900
T33x21.5x15	33.0±0.6	21.5±0.5	15.0±0.4	35.4	0.97	83.04	84.94	7053.98	3000	4200	7000	8900	12900	15400
T34x21.8x10	34.0±0.6	21.8±0.6	10.0±0.4	24.5	1.41	84.82	60	5090.27	2100	3000	4900	6200	8900	10700
T34x21.8x21	34.0±0.6	21.8±0.6	21.0±0.4	53.7	0.67	84.82	126.01	10689.6	4300	6100	10200	12900	18600	22200
T36x19x13	36.0±0.5	19.0±0.5	13.0±0.4	46.4	0.75	80.78	106.81	8628.65	3800	5400	8900	11400	16200	19500
T36x23x10	36.0±0.5	23.0±0.5	10.0±0.4	28.9	1.4	89.64	63.92	5730.59	2100	3000	4900	6300	9000	10800
T36x23x12	36.0±0.5	23.0±0.5	12.0±0.4	34.7	1.16	89.64	76.7	6876.71	2500	3600	5900	7500	10800	12900
T36x23x15	36.0±0.5	23.0±0.5	15.0±0.4	44	0.93	89.64	95.88	8595.89	3200	4400	7300	9400	13500	16000
T36x23x16	36.0±0.5	23.0±0.5	16.0±0.4	46	0.87	89.64	102.27	9168.95	3300	4600	7800	9900	14300	17100
T36x23x18	36.0±0.5	23.0±0.5	18.0±0.4	52	0.77	89.64	115.06	10315.1	3700	5300	8800	11200	16000	19200
T36x23x20	36.0±0.5	23.0±0.5	20.0±0.4	58.6	0.7	89.64	127.84	11461.2	4100	5900	9800	12400	17800	21300
T36x23x22	36.0±0.5	23.0±0.5	22.0±0.4	64	0.63	89.64	140.63	12607.3	4500	6500	10700	13600	19600	23500

Material: M3, MC95, M5K, M7K, M10K, M12K

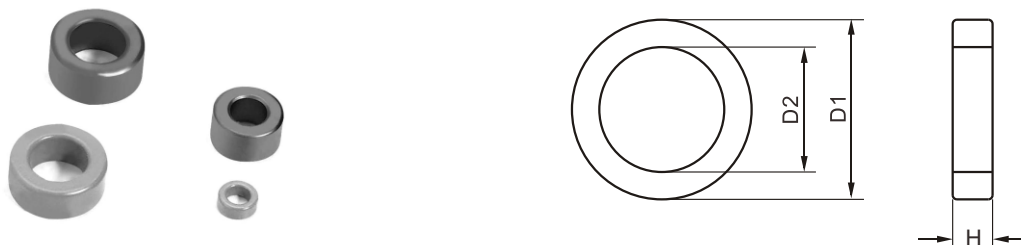

Type	Dimension(mm)			Weight (g)	Effective Parameter				AL(nH/N ²)					
	D1	D2	H		C1 (mm ⁻¹)	Le (mm)	Ae (mm ²)	Ve (mm ³)	M3 (±30%)	MC95 (±30%)	M5K (±30%)	M7K (±30%)	M10K (±30%)	M12K (±30%)
T37x22x10	37.0±0.5	22.0±0.5	10.0±0.4	33.5	1.2	88.63	73.33	6499.56	2400	3400	5600	7200	10400	12400
T37x22x12	37.0±0.5	22.0±0.5	12.0±0.4	40.8	1	88.63	88	7799.47	2900	4100	6800	8600	12400	14800
T37x22x15	37.0±0.5	22.0±0.5	15.0±0.4	51.2	0.8	88.63	110	9749.34	3600	5100	8500	10800	15400	18500
T37x23x15	37.0±0.5	23.0±0.5	15.0±0.4	48.5	0.88	90.78	103.04	9355.27	3300	4700	7800	9900	14200	17000
T38x19x10	38.0±0.5	19.0±0.5	10.0±0.4	40	0.9	82.74	91.28	7553.76	3100	4500	7400	9400	13300	16000
T38x19x13	38.0±0.5	19.0±0.5	13.0±0.4	52.8	0.69	82.74	118.67	9819.89	4000	5800	9300	12000	17000	20600
T38x19x15	38.0±0.5	19.0±0.5	15.0±0.4	61.5	0.6	82.74	136.92	11330.7	4600	6600	11000	14000	20000	24000
T38x19x17	38.0±0.5	19.0±0.5	17.0±0.4	69.8	0.53	82.74	155.18	12841.4	520	7400	12400	15800	22600	27000
T38x19x21	38.0±0.5	19.0±0.5	21.0±0.4	85	0.43	82.74	191.7	15862.9	6400	9200	15400	19600	28000	33400
T38x20.5x12	38.0±0.5	20.5±0.5	12.0±0.4	45.8	0.84	86.3	101.72	8780.02	3300	4700	7800	1000	14100	17000
T38x20.5x15	38.0±0.5	20.5±0.5	15.0±0.4	57.5	0.67	86.3	127.16	10975	4100	5900	9800	12500	17800	21300
T38x22x14	38.0±0.5	22.0±0.5	14.0±0.4	50.7	0.82	89.71	109.25	9801.56	3400	4900	8200	10400	14800	17700
T38x22x15	38.0±0.5	22.0±0.5	15.0±0.4	53.4	0.82	89.71	109.25	9801.56	3600	5200	8800	11200	15900	19000
T38x22x16	38.0±0.5	22.0±0.5	16.0±0.4	58	0.71	89.71	124.86	11201.8	3900	5600	9300	11900	16900	20200
T38x22x19	38.0±0.5	22.0±0.5	19.0±0.4	68.4	0.6	89.71	148.27	13302.1	4600	6600	11000	14000	20000	24100
T38x25x10	38.0±0.5	25.0±0.5	10.0±0.4	29.4	1.5	96.12	64.05	6157.74	1800	2700	4500	5700	8100	9800
T38x25x12	38.0±0.5	25.0±0.5	12.0±0.4	35.5	1.25	96.12	76.87	7389.29	2200	3200	5400	6900	9800	11700
T38x25x15	38.0±0.5	25.0±0.5	15.0±0.4	46	1	96.12	96.08	9236.61	2800	4000	6800	8600	12200	14700
T38x25x16	38.0±0.5	25.0±0.5	16.0±0.4	48.3	0.93	96.12	102.49	9852.38	3000	4300	7200	9200	13100	15600
T38x25x22	38.0±0.5	25.0±0.5	22.0±0.4	68.2	0.68	96.12	140.92	13547	4100	5900	9900	12700	18000	21700
T40x23x20	40.0±0.8	23.0±0.6	20.0±0.5	81	0.56	94.08	165.72	15592.3	4900	7100	11800	15100	21500	25800
T40x24x16	40.0±0.8	24.0±0.6	16.0±0.4	63.5	0.76	96.28	125.25	12060.4	3600	5200	8800	11200	16000	19000
T40x24x20	40.0±0.8	24.0±0.6	20.0±0.5	80.3	0.61	96.28	156.56	15075.5	4600	6600	11000	14000	20000	24000
T42x26x12.6	42.0±0.8	26.0±0.6	12.6±0.4	51.7	1.03	102.82	98.89	10168.6	2700	3900	6500	8300	11800	14200
T42x26x13	42.0±0.8	26.0±0.6	13.0±0.4	53.8	1	102.82	102.02	10491.4	2800	4000	6700	8500	12200	14600
T42x26x15	42.0±0.8	26.0±0.6	15.0±0.4	61.8	0.87	102.82	117.72	12105.5	3200	4600	7700	9800	14000	16900
T42x26x16	42.0±0.8	26.0±0.6	16.0±0.4	66.9	0.81	102.82	125.57	12912.5	3400	4900	8200	10500	15000	18000
T42x26x18	42.0±0.8	26.0±0.6	18.0±0.6	75.7	0.72	102.82	141.27	14526.5	3800	5500	9300	11800	16900	20300
T42x26x20	42.0±0.8	26.0±0.6	20.0±0.4	84.1	0.65	102.82	156.96	16140.6	4300	6200	10300	13100	18800	22500
T42x26x25	42.0±0.8	26.0±0.6	25.0±0.4	105	0.52	102.82	196.21	20175.8	5400	7700	12900	16400	23500	28200

Material: M3, MC95, M5K, M7K, M10K, M12K

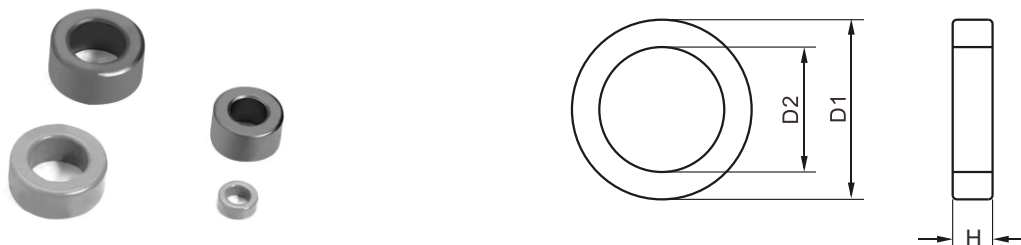

Type	Dimension(mm)			Weight (g)	Effective Parameter				AL(nH/N ²)					
	D1	D2	H		C1 (mm ⁻¹)	Le (mm)	Ae (mm ²)	Ve (mm ³)	M3 (±30%)	MC95 (±30%)	M5K (±30%)	M7K (±30%)	M10K (±30%)	M12K (±30%)
T45x30x13	45.0±0.8	30.0±0.6	13.0±0.4	55.4	1.19	114.64	96.17	11025.8	2300	3400	5700	7200	10400	12400
T45x30x15	45.0±0.8	30.0±0.6	15.0±0.4	63.6	1.03	114.64	110.97	12722	2700	3900	6600	8400	12000	14400
T47x27x15	47.0±0.8	27.0±0.6	15.0±0.4	84	0.75	110.49	146.21	16156	3700	5300	8900	11300	16200	19400
T48x30x10	48.0±1.0	30.0±0.5	10.0±0.3	55	1.33	118.12	88.36	10437.7	2100	3000	5000	6400	9200	11000
T48x30x15	48.0±1.0	30.0±0.5	15.0±0.4	79	0.89	118.12	132.54	15656.5	3100	4500	7600	9600	13800	16600
T48x30x22	48.0±0.8	30.0±0.8	22.0±0.5	113.5	0.6	118.12	194.39	22962.9	4600	6700	11100	14200	20300	24300
T49x31x15	49.0±0.6	31.0±0.6	15.0±0.4	81	0.91	121.37	132.66	16102.9	3100	4400	7400	9400	13500	16200
T49x31x19	49.0±0.6	31.0±0.6	18.8±0.3	103	0.72	121.37	168.04	20397	3900	5600	9400	11900	17100	20500
T49x31.8x15.8	49.0±0.6	31.8±0.6	15.8±0.3	80.5	0.91	123.05	133.78	16462.1	3000	4400	7300	9400	13400	16100
T49x31.8x16	49.0±0.6	31.8±0.6	16.0±0.3	80.5	0.9	123.05	135.47	16670.5	3100	4500	7400	9500	13600	16300
T49x31.8x19	49.0±0.6	31.8±0.6	18.8±0.3	97.8	0.76	123.05	160.87	19796.2	3700	5300	8890	11300	16100	19400
T49x33.8x16	49.0±0.6	33.8±0.6	16.0±0.3	76.6	1.05	127.11	120.21	15281.4	2700	3800	6400	8200	11700	14000
T49x33.8x19	49.0±0.6	33.8±0.6	19.0±0.3	92.5	0.89	127.11	142.75	18146.6	3200	4600	7600	9700	13900	16700
T49x33.8x20	49.0±0.6	33.8±0.6	20.0±0.3	96.5	0.84	127.11	150.26	19101.7	3300	4800	8000	10200	14600	17600
T49x33.8x31.6	49.0±0.6	33.8±0.6	31.6±0.3	160	0.53	127.11	237.41	30180.7	5300	7600	12700	16200	23200	27800
T50x25x15	50.0±1.0	25.0±0.6	15.0±0.6	104	0.6	108.87	180.16	19616.8	4600	6600	11000	14000	20000	24000
T50x25x19	50.0±1.0	25.0±0.6	19.0±0.6	132	0.47	108.87	228.21	24847.9	5800	8300	13900	17700	25300	30400
T50x25x20	50.0±1.0	25.0±0.6	20.0±0.6	138.5	0.45	108.87	240.22	26155.7	6100	8800	14600	18600	26600	32000
T50x30x13	50.0±1.0	30.0±0.6	13.0±0.6	80	0.94	120.36	127.2	15311	2900	4200	7100	9100	13000	15600
T50x30x19	50.0±1.0	30.0±0.6	19.0±0.6	118.5	0.64	120.36	185.92	22377.6	4300	6200	10400	13300	19000	22800
T50x30x20	50.0±1.0	30.0±0.6	20.0±0.6	122.5	0.61	120.36	195.7	23555.4	4600	6600	11000	14000	20000	24000
T50x30x25	50.0±1.0	30.0±0.6	25.0±0.6	154	0.49	120.36	244.63	29444.3	5700	8200	13700	17500	25000	30000
T50x30x26	50.0±1.0	30.0±0.6	26.0±0.6	159.5	0.47	120.36	254.41	30622	5900	8500	14300	18200	26000	31200
T51x31x10	51.5±1.0	31.5±0.8	10.0±0.4	63.5	1.27	125.26	98.01	12277.7	2200	3100	5300	6700	9600	11500
T51x31x13	51.5±1.0	31.5±0.8	13.0±0.4	74	0.98	125.26	127.41	15907	2800	4100	6900	8700	12500	15000
T51x31x17	51.5±1.0	31.5±0.8	17.0±0.4	100	0.75	125.26	166.61	20872	3700	5400	9000	11400	16300	19600
T51x31x24.5	51.5±1.0	31.5±0.8	24.5±0.6	150	0.52	125.26	240.12	30080.3	5400	7700	12900	16500	23600	28300
T51x31x25	51.5±1.0	31.5±0.8	25.0±0.6	152	0.51	125.26	245.02	30694.2	5500	7900	13200	16800	2400	28900
T56x26x20	56.2±1.0	26.0±0.6	26.0±0.6	189	0.4	116.98	285.7	33423.3	6700	9600	16000	20000	29000	35100
T56x28x20	56.0±1.0	28.0±0.8	20.0±0.6	180	0.45	121.94	269.05	32809.7	6100	8800	14600	18600	26000	32000

Material: M3, MC95, M5K, M7K, M10K, M12K

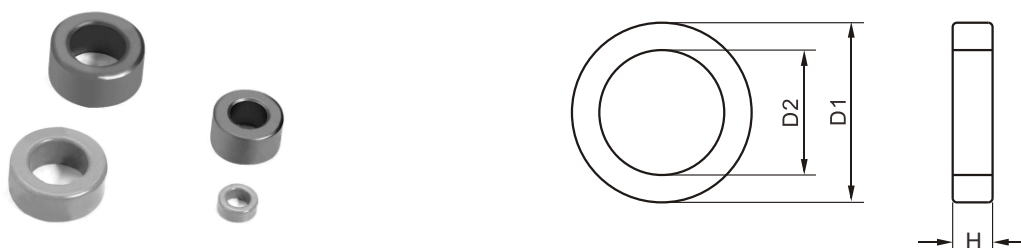

Type	Dimension(mm)			Weight (g)	Effective Parameter				AL(nH/N ²)					
	D1	D2	H		C1 (mm ⁻¹)	Le (mm)	Ae (mm ²)	Ve (mm ³)	M3 (±30%)	MC95 (±30%)	M5K (±30%)	M7K (±30%)	M10K (±30%)	M12K (±30%)
T56x32x15	56.0±1.0	32.0±1.0	15.0±0.6	118	0.74	131.27	175.37	23021.6	3700	5400	9000	11400	16300	19600
T56x32x16.5	56.0±1.0	32.0±1.0	16.5±0.6	130	0.68	131.27	192.91	25323.7	4100	5900	9900	12600	18000	21600
T56x32x18	56.0±1.0	32.0±1.0	18.0±0.6	143	0.62	131.27	210.45	27625.9	4500	6400	10800	13700	19600	23500
T56x32x20	56.0±1.0	32.0±1.0	20.0±0.6	159	0.56	131.27	233.83	30695.4	5000	7200	12000	15273	21818	26182
T56x36x20	56.0±1.0	36.0±1.0	20.0±0.6	140	0.71	139.91	196.77	27532.4	4000	5700	9500	12100	17300	20800
T58x38x21.4	57.5±1.5	38.3±1.0	21.4±0.6	148	0.72	146.41	202.63	29670	3900	5600	9400	12000	17100	20500
T58x40x18	58.0±1.5	40.0±1.0	18.0±0.6	120	0.93	150.45	160.14	24094.8	3900	5600	9400	12000	17100	20500
T60x35x20	60.0±1.5	35.0±1.0	20.0±0.6	185	0.58	142.23	244.03	34710.9	4600	6600	11000	14000	20000	24000
T60x38x20	60.0±1.5	38.0±1.0	20.0±0.6	170	0.68	148.71	216.21	32153.9	4100	5900	9800	12500	17900	21500
T60x40x18	60.0±1.5	40.0±1.0	18.0±0.6	141	0.86	152.85	177.55	27140.3	3300	4700	7900	10000	14400	17000
T60x40x20	60.0±1.5	40.0±1.0	20.0±0.6	150	0.77	152.85	197.28	30155.9	3600	5200	8800	11200	16000	19000
T60x40x25	60.0±1.5	40.0±1.0	25.0±0.6	198	0.61	152.85	246.6	37694.9	4600	6600	11000	14000	20000	24000
T63x38x12.7	63.0±1.0	38.0±0.5	12.7±0.5	120	0.97	152.08	155.41	23636.4	2900	4100	6900	8800	12500	15000
T63x38x20	63.0±1.5	38.0±1.0	20.0±0.8	193.5	0.62	152.08	244.74	37222.6	4500	6500	10800	13800	19800	23500
T63x38x21	63.0±1.5	38.0±1.0	21.0±0.8	200	0.59	152.08	256.97	39083.7	4700	6800	11400	14500	20700	24700
T63x38x25	63.0±1.5	38.0±1.0	25.0±0.8	238	0.49	152.08	305.92	46528.3	5700	8100	13600	17300	24700	29500
T61.8x39x31.8	61.8±1.5	39.0±1.0	31.8±0.8	276	0.37	152.08	403.82	61417.3	7500	10700	17900	22800	32600	39000
T68x44x12.7	68.0±1.5	44.0±0.8	12.7±0.5	130	1.13	170.49	150.01	25576.7	2100	2900	4900	6300	9000	10500
T68x44x15	68.0±1.5	44.0±0.8	15.0±0.5	152	0.96	170.49	177.18	30208.7	2400	3500	5800	7400	10600	12500
T68x44x25	68.0±1.5	44.0±1.0	25.0±0.5	263	0.57	170.49	295.3	50347.8	4000	5800	9700	12400	17700	21000
T74x40x13	74.0±1.5	40.0±1.0	13.0±0.4	191	0.78	168.25	214.16	36033.6	3500	5100	8500	10800	15500	18500
T74x44x20	75.0±1.5	44.0±1.0	20.0±0.5	272	0.51	168.25	329.47	55436.3	5400	7800	13100	16700	23800	28500
T78x50x20	78.0±1.5	50.0±1.0	20.0±0.5	275	0.7	194.58	275.43	53594.8	4000	5700	9600	12200	17500	21000
T80x40x15	80.0±1.5	40.0±1.0	15.0±0.5	272	0.6	174.2	288.27	50218.9	4600	6600	11000	14000	20000	24000
T80x50x20	80.0±1.5	50.0±1.0	20.0±0.8	293	0.66	196.87	294.53	57987.1	4200	6000	10100	12900	18400	22000
T80x50x25	80.0±1.5	50.0±1.0	25.0±0.8	378	0.53	196.87	368.17	72483.8	5300	7600	12600	16100	23000	27500
T85x55x25	85.0±2.0	55.0±1.5	25.0±0.5	388	0.53	196.87	368.17	72483.8	4900	7000	11700	15000	21400	25500
T85x55.4x25	85.2±2.0	55.4±1.5	25.0±0.5	404	0.58	213.94	364.4	77962.1	4800	6900	11500	14700	21000	25000
T86x57x25.4	86.0±2.0	57.0±1.5	25.4±0.5	406	0.6	218.41	363.15	79317.3	4700	6700	11300	14400	20600	24500
T86x63x30	86.0±2.0	63.0±1.5	30.0±0.5	388	0.67	230.31	342.22	78819.7	4200	6100	10100	12900	18000	22000

T CORES

Meisongbei

Material: M3, MC95, M5K, M7K, M10K, M12K

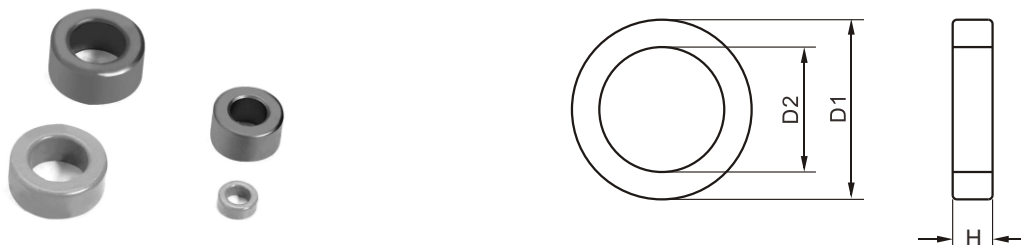

Type	Dimension(mm)			Weight (g)	Effective Parameter				AL(nH/N ²)					
	D1	D2	H		C1 (mm ⁻¹)	Le (mm)	Ae (mm ²)	Ve (mm ³)	M3 (±30%)	MC95 (±30%)	M5K (±30%)	M7K (±30%)	M10K (±30%)	M12K (±30%)
T87x54x14	87.0±2.0	55.0±2.0	14.0±0.5	245	0.97	215.42	220.11	47418	2900	4000	6800	8700	12500	15000
T87x54x15	87.0±2.0	55.0±2.0	14.8±0.5	259	0.91	215.42	235.83	50805	3100	4400	7200	9200	13300	16000
T87x54x30	87.0±2.0	55.0±2.0	30.0±1.0	526	0.45	215.42	471.67	101610	6200	8900	14000	18300	26500	32000
T87x55x12.7	87.0±2.0	55.0±2.0	12.7.0±1.0	218	1.07	215.42	199.67	43014.9	2600	3700	6000	7800	11000	13200
T87x55x13.8	87.0±2.0	55.0±2.0	13.8±1.0	233	0.99	215.42	216.97	46740.6	2800	4000	6500	8500	12000	14500
T90x57x25.4	90.0±2.0	57.0±2.0	25.4±0.6	473	0.54	223.06	411.88	91879.8	5200	7500	12000	15000	22000	27000
T100x50x20	100.0±2.0	50.0±2.0	20.0±0.4	580	0.45	217.75	480.45	104623	6100	8800	14400	18400	26400	31500
T102x66x15	102.0±2.0	66.0±2.0	15.0±0.6	345	0.96	255.73	265.77	67969.6	2900	4200	7000	9000	12500	15000